

INDENTED HEAD MARKING .010 MAX DEPTH.
IDENTIFY WITH PART NUMBER "210",
MANUFACTURER'S TRADEMARK "hs", AND
FIRST DASH NUMBER. LOCATION OPTIONAL.

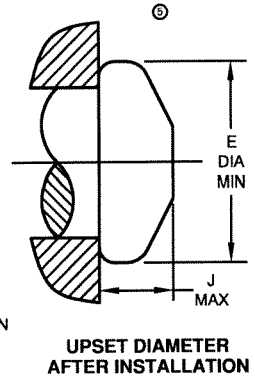
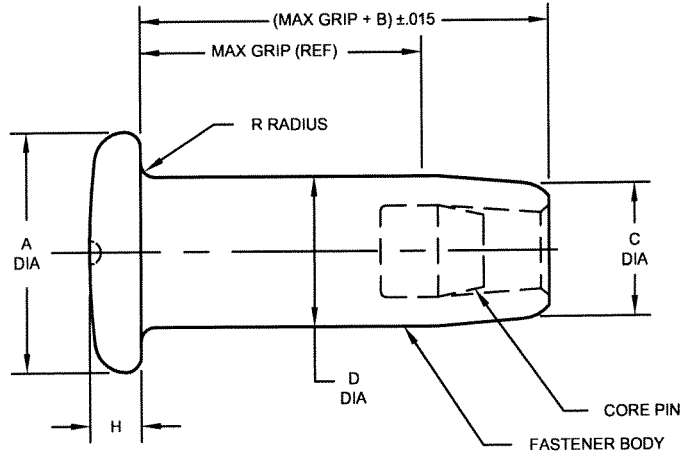
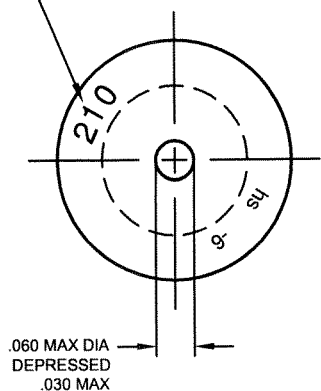

FIRST DASH NO.	NOM DIA.	A DIA.	B	C REF.	D		E DIA. MIN.	H	J MAX.	R RAD REF.	GRIP VAR.	SECOND DASH NUMBER AVAILABILITY	DOUBLE SHEAR POUNDS MIN.	TENSION POUNDS MIN.
					MIN. BEFORE FINISH	AFTER FINISH								
6	3/16	.377 .357	.182	.177	.1890	.1905 .1894	245	.080 .067	.130	.025	1/16	-3 and Up	5,380	2,750

- Ⓢ NOTES: 1. Concentricity: A diameter to D diameter within .005 FIM.
2. Surface texture: $125/\sqrt{\text{in}}$ maximum per ANSI B46.1.
3. See table for grip length availability. Minimum grip is one grip variation increment below the maximum grip.
4. Dimensions to be met after finish.

MATERIAL: A-286 Cres per AMS5731.

HEAT TREAT: 95,000 psi shear minimum.

Ⓢ FINISH: HSR210AP(-)(-) = Hi-Kote 1 aluminum coating per Hi-Shear Spec. 294, and cetyl alcohol lube per Hi-Shear Spec. 305.

Ⓢ PROCUREMENT: Hi-Set Fastener Specification 332.

Ⓢ CODE: First dash number indicates nominal diameter in 1/32nds. Second dash number indicates maximum grip in 1/16ths. See Finish note for explanation of code letters.

Ⓢ HOW TO ORDER

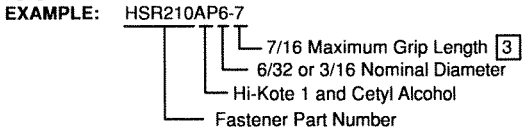

U.S. Patent Numbers
3,995,406; 4,126,076; 4,223,433.
"Hi-Set" is a registered trademark of
Hi-Shear Corporation

	DATE	BY
DRAWN	01-10-96	J.F.Obispo
APPROVED	01-11-96	JRausch
5 REVISION	10-25-01	D. Hocking

TITLE
HI-SET® FASTENER
PROTRUDING CROWN TENSION HEAD
A-286 CRES
95 KSI SHEAR

DRAWING NUMBER
HSR210
Sheet 1 of 1